

TOWN OF YOUNTVILLE

MEASURE T WASHINGTON STREET REHABILITATION MT-3026

GENERAL NOTES:

- A NO FEE ENCROACHMENT PERMIT MUST BE OBTAINED PRIOR TO ANY/ALL WORK IN PUBLIC RIGHT-OF-WAY.
- THE TOWN OF YOUNTVILLE IS A MEMBER OF THE UNDERGROUND SERVICE ALERT (U.S.A) ONE CALL PROGRAM. ALL CONTRACTORS ON THIS PROJECT SHALL NOTIFY U.S.A 48 HOURS (2 WORKING DAYS) IN ADVANCE OF PERFORMING ANY EXCAVATION WORK OR DEMOLITION OF IMPROVEMENTS. THE TOLL FREE PHONE NUMBER IS 811. ALL USA MARKINGS SHALL BE OF CHALK PAINT AND FULLY REMOVED WHEN NO LONGER NEEDED. PAINTING OVER USA MARKINGS IS NOT ACCEPTABLE.
- TRAFFIC CONTROL DURING CONSTRUCTION SHALL BE THE CONTRACTOR'S RESPONSIBILITY. ALL TRAFFIC CONTROL AND DEVICES SHALL BE IN ACCORDANCE WITH THE LATEST EDITION OF THE "MANUAL OF UNIFORM TRAFFIC CONTROL DEVICES" ISSUED BY THE STATE OF CALIFORNIA DEPARTMENT OF TRANSPORTATION. LANE CLOSURES SHALL CONFORM TO STATE STANDARD PLANS.
- TOWN STREETS ARE TO REMAIN OPEN TO THROUGH TRAFFIC AT ALL TIMES.
- NO TEMPORARY OR LONG TERM PARKING OR STORAGE OF CONSTRUCTION EQUIPMENT OR MATERIALS SHALL OCCUR WITHOUT PRIOR ISSUANCE OF AN ENCROACHMENT PERMIT.
- CONTRACTOR SHALL MAINTAIN AN ACCESSIBLE PATH FOR PEDESTRIANS AND TRAFFIC TO BUILDINGS AND AROUND THE WORK AS NECESSARY THROUGHOUT THE LIFE OF THE CONTRACT AS SPECIFIED IN THE SPECIAL CONDITIONS.
- THE CONTRACTOR SHALL PROVIDE FOR CONTINUOUS INGRESS AND EGRESS TO ALL PRIVATE PROPERTY ADJACENT TO THE WORK THROUGHOUT THE PERIOD OF CONSTRUCTION
- DURING THE CONSTRUCTION PERIOD, THE PROJECT AREA(S) SHALL BE SWEEPED DAILY AND KEPT FREE OF DIRT, DUST AND DEBRIS. AT THE CONCLUSION OF CONSTRUCTION AND PRIOR TO THE ISSUANCE OF NOTICE OF COMPLETION, THE AREA(S) SHALL BE INSPECTED BY THE TOWN'S REPRESENTATIVE AND REPAIRS COMPLETED AS DIRECTED TO THE SATISFACTION OF THE TOWN.
- THE CONTRACTOR SHALL REMOVE ALL BRANCHES WHICH HANG WITHIN 15 FEET ABOVE FINISHED ROADWAY GRADE & ALL OTHER VEGETATION ALONG ROADWAY & IN LIMITS OF WORK AREA. VEGETATION SHALL BE TRIMMED A MINIMUM OF 12-INCHES BEYOND THE EDGE OF PAVEMENT OR AS NECESSARY FOR COLD PLANING & PAVING OPERATIONS & OTHER OPERATIONS AS REQUIRED. PRIOR TO TRIMMING ANY VEGETATION WITHIN OR OUTSIDE THE TOWN'S RIGHT-OF-WAY, THE TOWN & RESIDENTS SHALL BE NOTIFIED ONE (1) WEEK PRIOR TO WORK TO ALLOW THE TOWN OR AFFECTED RESIDENT THE OPPORTUNITY TO TRIM ANY VEGETATION THAT MAY BE IMPACTED BY THE CONTRACTOR'S WORK.
- CONTRACTOR SHALL DISPOSE OF ALL PROJECT WASTE IN A LEGAL MANNER. WASTE MATERIALS SHALL NOT BE WASHED INTO THE STORM DRAIN SYSTEM. THIS INCLUDES BUT IS NOT LIMITED TO SOIL, PAINT, GROUT, CONCRETE DUST, SAW RESIDUE, GRINDINGS, OIL, ETC.
- THE CONTRACTOR SHALL BE RESPONSIBLE FOR REPAIRING ANY DAMAGE TO THE SITE OR THE SURROUNDING AREA AS A RESULT OF THE CONTRACTOR'S WORK OR OPERATIONS. EXISTING FACILITIES THAT ARE DAMAGED OR DISPLACED BY THE CONTRACTOR SHALL BE REPLACED AT THE CONTRACTOR'S EXPENSE.
- ALL SURVEY MONUMENTS TO BE PROTECTED DURING CONSTRUCTION. ALL SURVEY MONUMENTS LOCATED WITHIN LIMIT OF PAVEMENT REHABILITATION WORK SHALL HAVE A TRAFFIC-RATED UTILITY BOX AND COVER INSTALLED.
- THE CORING INFORMATION SHOWN ON THE PLANS IS SOLELY A REPRESENTATION OF THE ROADWAY SECTION & IN NO WAY INDICATES WHAT THE EXISTING CONDITIONS MAY BE DURING CONSTRUCTION.
- THE CONTRACTOR IS RESPONSIBLE FOR FIELD VERIFYING THE LOCATIONS, ELEVATIONS, ETC. OF EXISTING FACILITIES AND SHALL IMMEDIATELY NOTIFY THE TOWN'S REPRESENTATIVE IN WRITING OF ANY FIELD CONFLICTS.
- THE CONTRACTOR SHALL ENSURE POSITIVE DRAINAGE TO THE EXISTING DRAINAGE FACILITIES FROM THE NEW AND EXISTING PAVEMENT SURFACES.
- CONTRACTOR IS RESPONSIBLE FOR REPLACING ALL TRAFFIC STRIPING & PAVEMENT MARKINGS DAMAGED OR OBLITERATED AS PART OF THEIR WORK. NEW TRAFFIC STRIPING & PAVEMENT MARKINGS SHALL BE THERMOPLASTIC.
- ALL UTILITIES ADJUSTED TO FINISH GRADE SHALL BE PERFORMED PER CITY OF NAPA STANDARD DRAWING NO. D-14, "STANDARD MANHOLE ADJUSTMENT". CONCRETE COLLAR SHALL BE FLUSH WITH THE ADJACENT PAVEMENT SURFACE & SHALL HAVE A LIGHT BROOM FINISH; NO ASPHALT CONCRETE SHALL BE ALLOWED. CARE SHALL BE TAKEN TO KEEP THE UTILITY FRAMES & COVERS, & PAVEMENT SURFACES CLEAN & FREE OF CONCRETE SPLATTER. ANY MATERIAL THAT ADHERES TO THE UTILITY FRAMES & COVERS OR PAVEMENT SURFACES SHALL BE IMMEDIATELY REMOVED TO THE SATISFACTION OF THE ENGINEER.

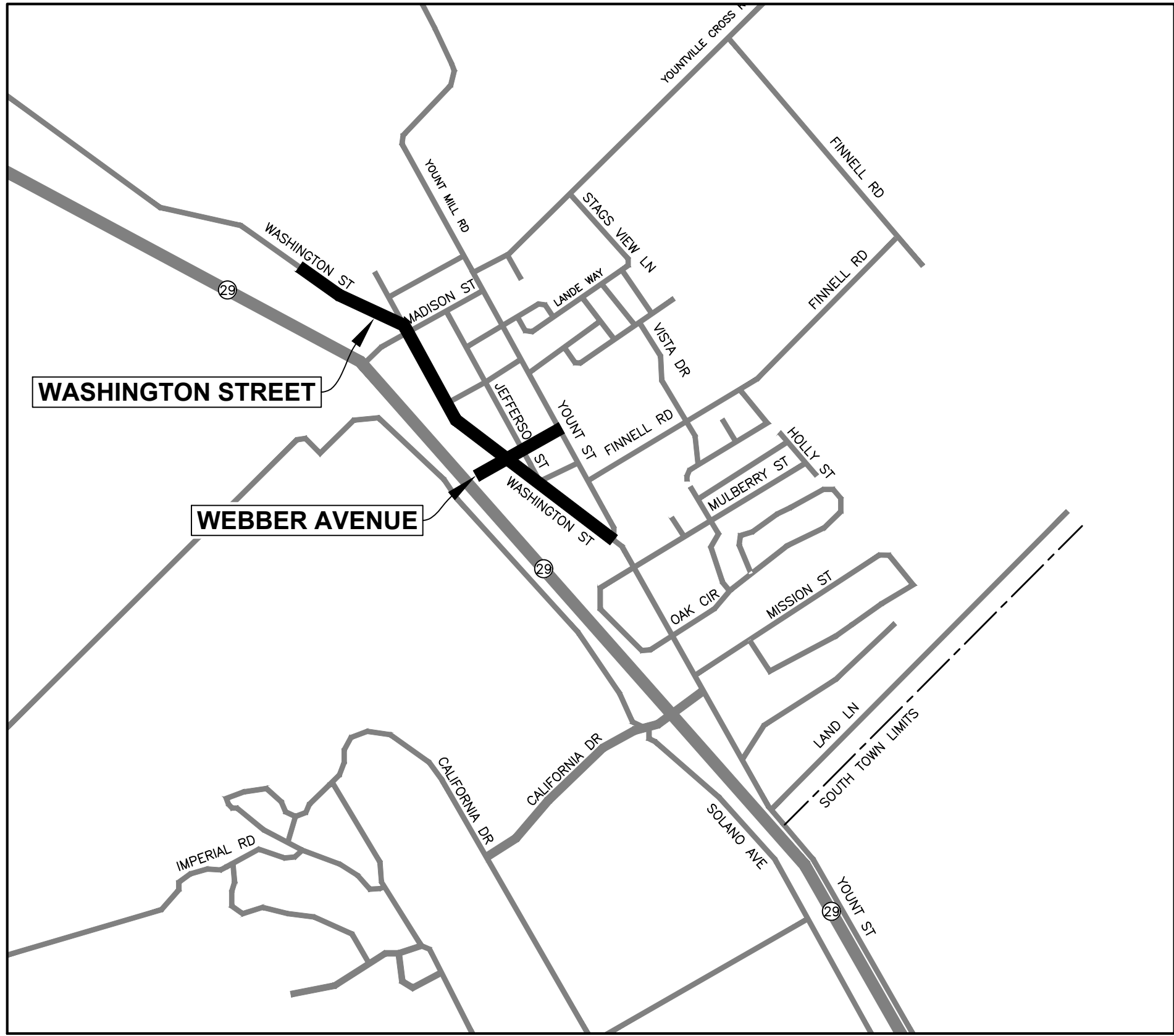

LOCATION MAP
NTS
NORTH

LEGEND

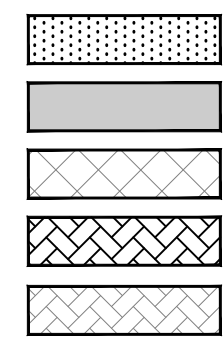

REMOVE & REPLACE X" HMA
(SEE PLAN FOR DEPTH "X")

PARTIAL DEPTH RECYCLE

COLD PLANE 4" & REPLACE 4" HMA

INSTALL ASPHALT PAVEMENT TEXTURING

EX. ASPHALT PAVEMENT TEXTURING

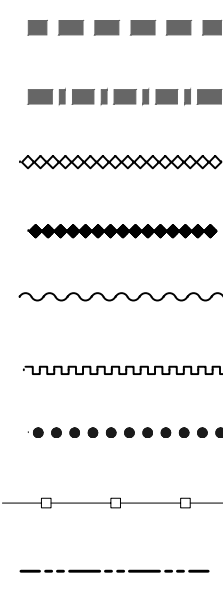

KEYCUT A1

KEYCUT A2

KEYCUT B1

KEYCUT B2

PAVEMENT TRANSITION

HMA DIKE

SHOULDER BACKING

GUARDRAIL

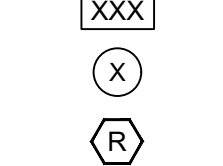

PROPERTY ADDRESS "XXX"

CONSTRUCTION NOTE "X"

PRUNE & REMOVE TREE ROOTS
(UNDER PCC/HMA REPAIRS)



BORING LOCATION
(SEE BORING LOG ON EACH SHEET)



CATCH BASIN



CURB INLET



DROP INLET



FIRE HYDRANT



GAS VALVE



JUNCTION BOX



MANHOLE
(D=STORM DRAIN, S=SEWER, T=AT&T)



ROADSIDE SIGN



SEWER CLEAN OUT COVER



SURVEY MONUMENT



WATER VALVE



12" WHITE CROSSWALK LINE (THERMO)



12" WHITE LIMIT LINE (THERMO)



BLUE RETROREFLECTIVE PAVEMENT MARKER



CALTRANS STRIPING DETAIL "XX"

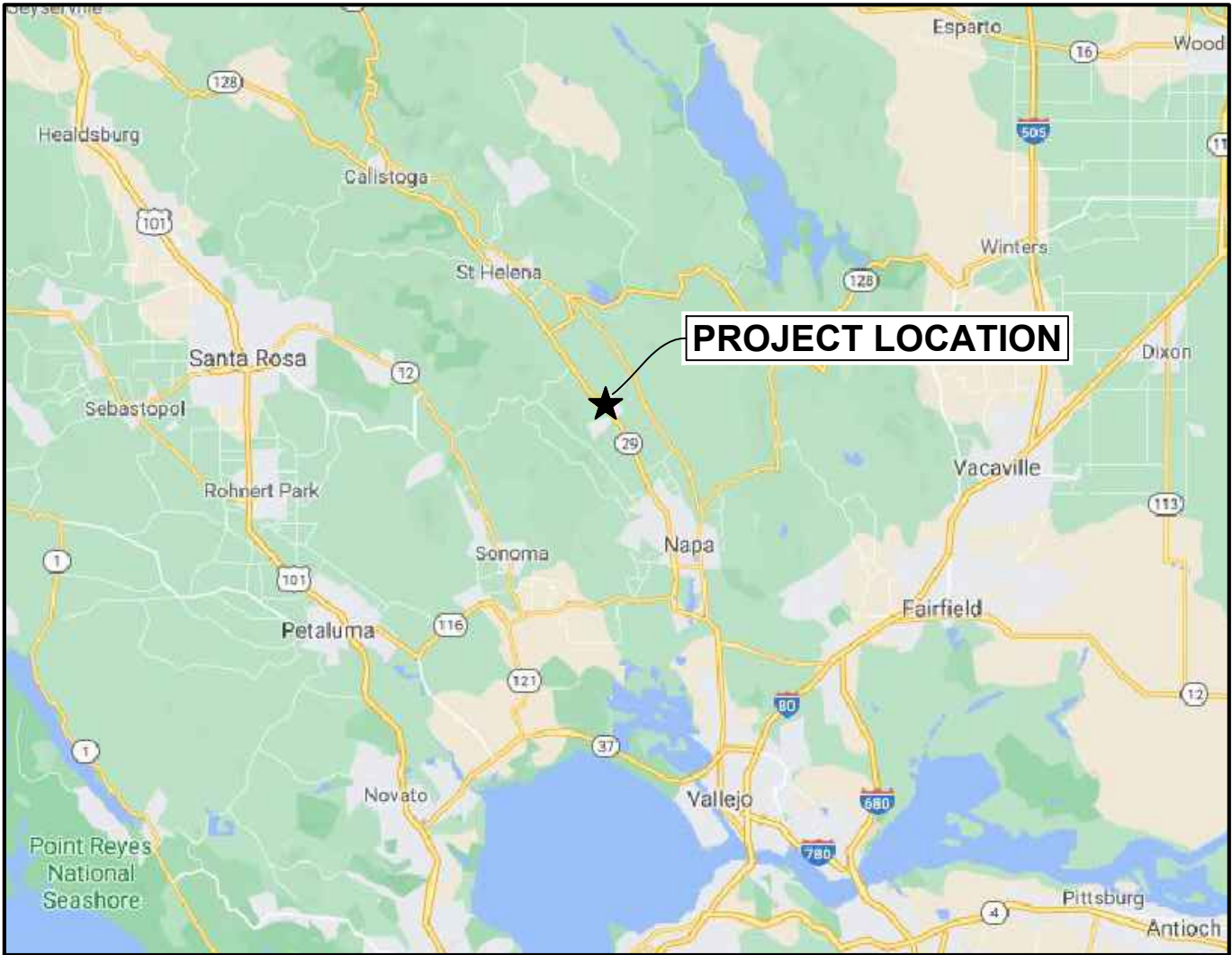

VICINITY MAP
NTS
NORTH

SHEET INDEX

SHEET NO.	SHEET TITLE	LIMITS
1	TITLE SHEET	---
2 - 5	WASHINGTON STREET	YOUNT STREET TO NORTH TOWN LIMIT
6	WEBBER AVENUE	YOUNT STREET TO WEST END



TOWN OF YOUNTVILLE
APPROVED FOR CONSTRUCTION

PUBLIC WORKS DIRECTOR

DATE

Pavement Engineering Inc.

You can ride on our reputation



Corporate Office:
3485 Sacramento Drive, Suite A
San Luis Obispo, CA 93401
805.781.2265

TOWN OF YOUNTVILLE
MT-3026; MEASURE T WASHINGTON STREET REHABILITATION

TITLE SHEET

DRAWN BY:

EN

PROJECT NUMBER:

250087-01

SCALE:

NO SCALE

VERIFY SCALE

BAR REPRESENTS

1" ON ORIGINAL

DATE:

APRIL 29, 2025

SHEET NUMBER:

1 of 6

P:\R\2\SHARED\R DRIVE\ACTIVE PROJECTS\YOUNTVILLE, TOWN OF\250087\DRAWINGS\250087-01_SITEL.DWG Plot Date: 4/29/2025 4:59 PM

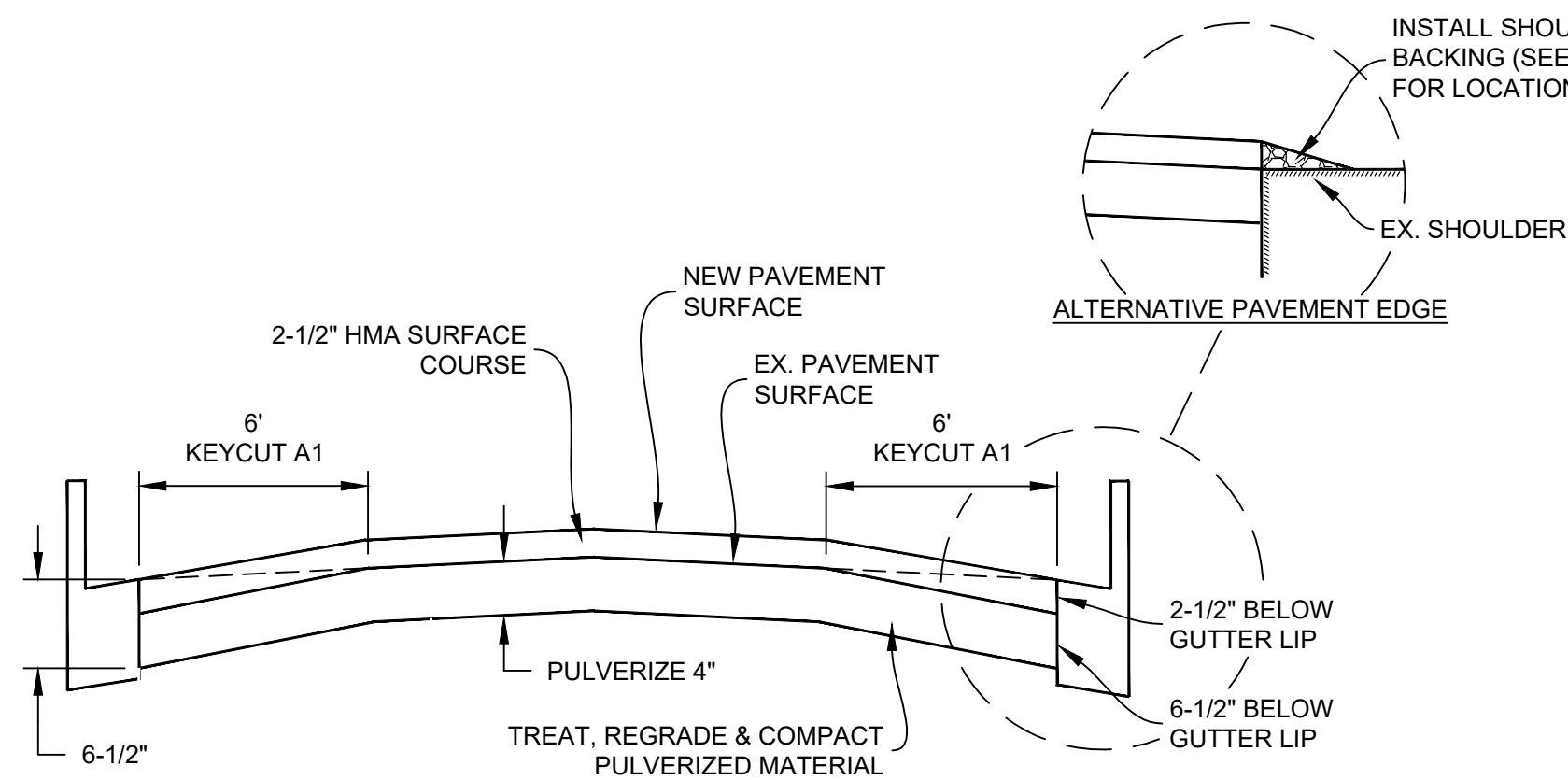
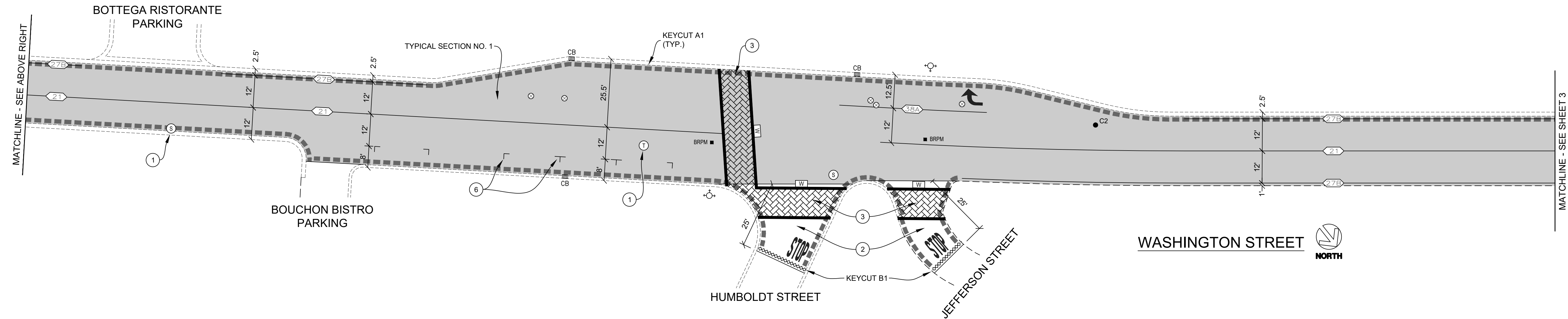
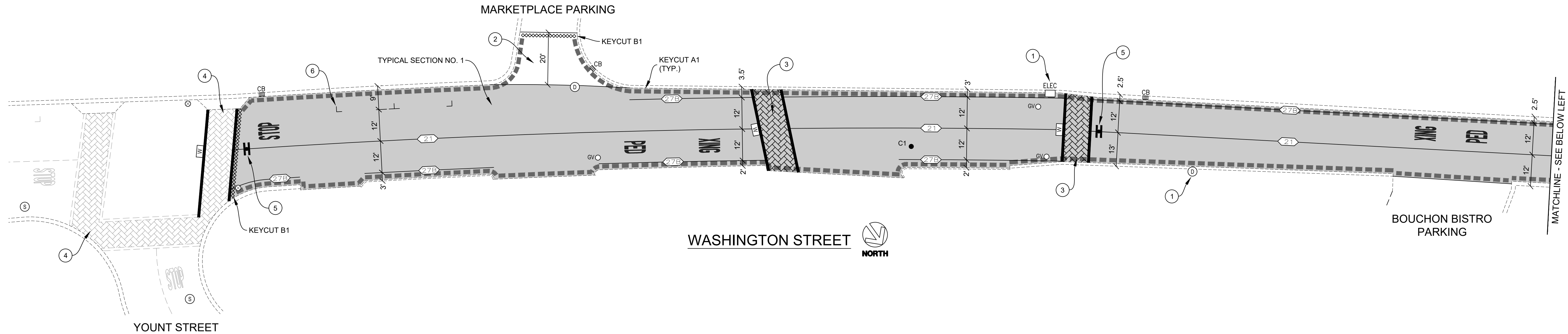

TYPICAL SECTION NO. 1
NTS

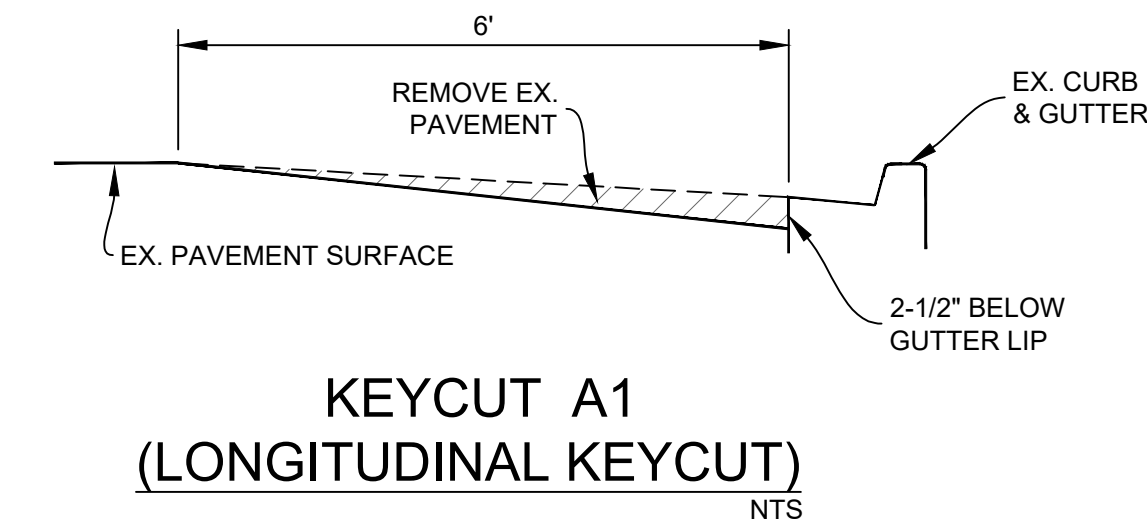

KEYCUT A1
(LONGITUDINAL KEYCUT)
NTS

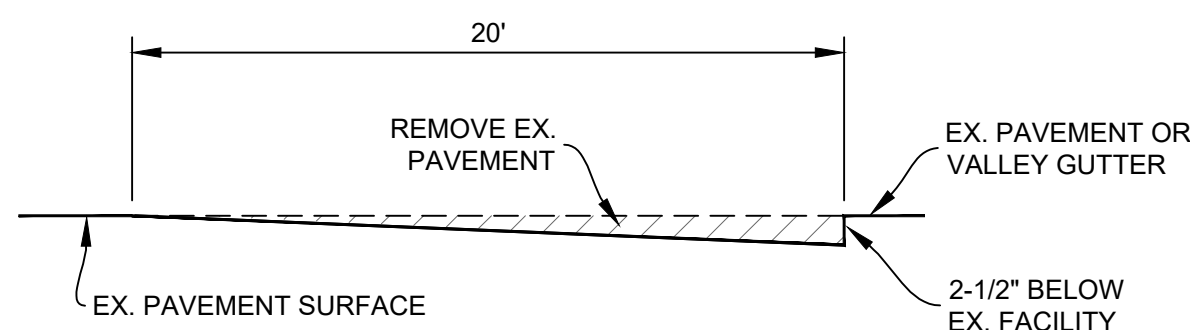

KEYCUT B1
(TRANSVERSE KEYCUT)
NTS

NOTE:
1. NEW SHOULDER BACKING MATERIAL SHALL MATCH EX. SHOULDER MATERIAL. 3/4\"/>

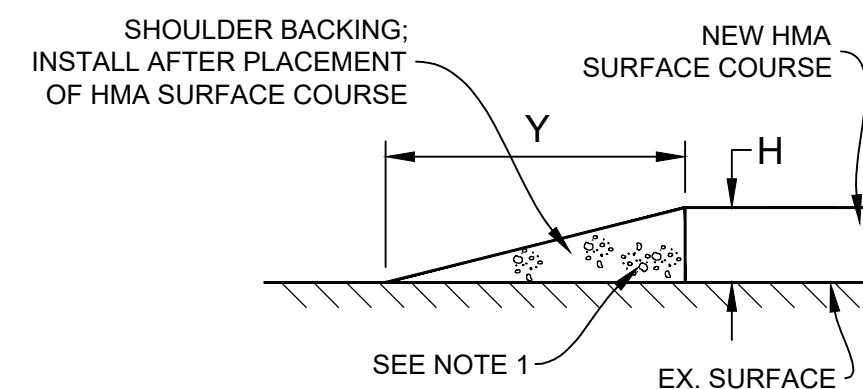

SHOULDER BACKING
NTS

DIMENSION SCHEDULE	
H	Y
0'-1"	1'-0"
1'-2"	2'-0"
2'-3"	3'-0"
3'-4"	4'-0"

MISCELLANEOUS NOTE:

1. LOWER ALL UTILITY COVERS WITHIN LIMITS OF TYPICAL SECTION NO. 1 PRIOR TO PULVERIZATION OR COLD PLANE & ADJUST ALL UTILITY COVERS TO FINISHED GRADE AFTER PLACEMENT OF FINAL SURFACE COURSE, UNLESS SHOWN OTHERWISE ON THE PLANS.

CONSTRUCTION NOTES:

- UTILITY COVER; PROTECT IN PLACE DURING PULVERIZATION, COLD PLANE & PAVING OPERATIONS.
- NO PARTIAL DEPTH RECYCLE WORK. 2-1/2" HMA SUFACE COURSE ONLY.
- INSTALL ASPHALT PAVEMENT TEXTURING AFTER PLACEMENT OF FINAL SURFACE COURSE. PATTERN & COLOR SHALL BE HERRINGBONE & BURNT SIENA, RESPECTIVELY.
- ASPHALT PAVEMENT TEXTURING; PROTECT IN PLACE.
- REMOVE & REPLACE ROADSIDE SIGN (R1-6 WITH FIXED BASE).
- REMOVE & REPLACE PAVEMENT MARKING PARKING "L" & "T" (THERMO), TYP. STALL LENGTH VARIES; MATCH EXISTING.

BORING LOG

NO.	AC	PCC	AB	R-VALUE	FABRIC (Y/N)
C1	7"	5"	0"	21	Y
C2	5"	5-1/2"	0"	-	Y

*CORING DATA IS FOR INFORMATION ONLY. EXISTING SECTION MAY VARY FROM SECTION(S) FOUND AT CORING LOCATION(S). FABRIC MAY BE PRESENT IN SECTIONS EVEN IF NOT FOUND AT CORING LOCATION(S).

Pavement Engineering Inc.

You can ride on our reputation

Corporate Office:
3485 Sacramento Drive, Suite A
San Luis Obispo, CA 93401
805.781.2265

TOWN OF YOUNTVILLE
MT-3026, MEASURE T WASHINGTON STREET REHABILITATION

WASHINGTON STREET
YOUNT STREET TO NORTH TOWN LIMIT

DRAWN BY: EN

PROJECT NUMBER: 250087-01

SCALE: 1" = 20'

VERIFY SCALE

BAR REPRESENTS 1" ON ORIGINAL

DATE: APRIL 29, 2025

SHEET NUMBER:

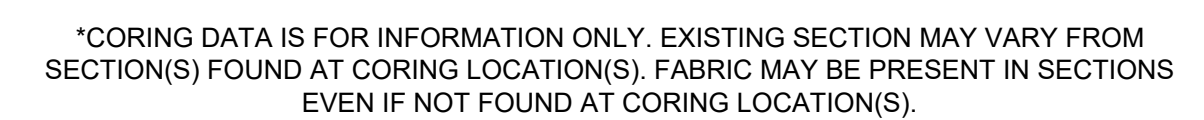

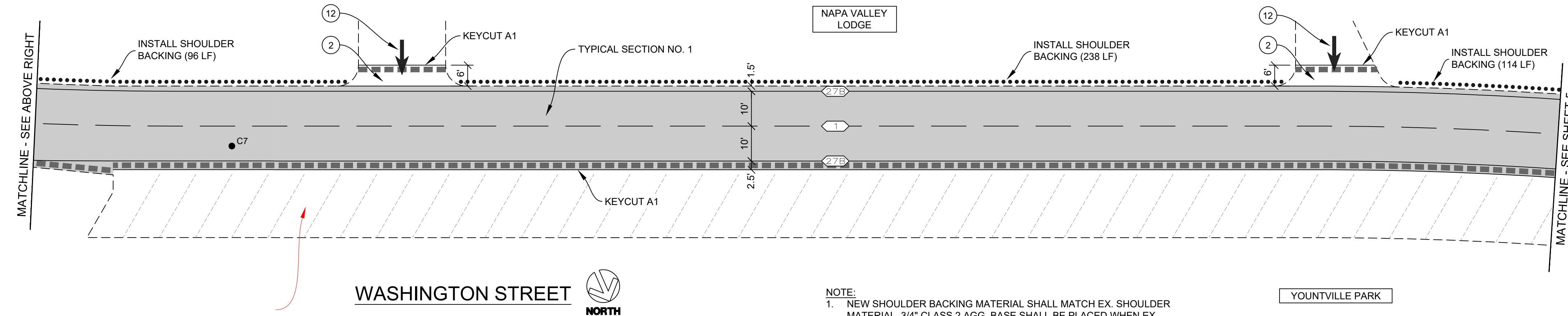

- 1 UTILITY COVER; PROTECT IN PLACE DURING PULVERIZATION, COLD PLANE & PAVING OPERATIONS.
- 2 NO PARTIAL DEPTH RECYCLE WORK. 2-1/2" HMA SURFACE COURSE ONLY.
- 3 INSTALL ASPHALT PAVEMENT TEXTURING AFTER PLACEMENT OF FINAL SURFACE COURSE. PATTERN & COLOR SHALL BE HERRINGBONE & BURNT SIENNA, RESPECTIVELY.
- 7 6" WHITE LINE (THERMO), TYP. STALL LENGTH & WIDTH SHALL BE 21' & 8.5" RESPECTIVELY. REFRESH STRIPING OUTSIDE OF PAVING LIMITS.
- 12 REFRESH PAVEMENT MARKING OUTSIDE OF PAVING LIMITS.
- 13 BIKE BUFFER HATCHING. 6" WHITE LINE (THERMO) SPACED AT 10' O.C.
- 14 6" WHITE LINE (PAINT), TYP. STALL LENGTH & WIDTH SHALL BE 18' & 9", RESPECTIVELY.

1. LOWER ALL UTILITY COVERS WITHIN LIMITS OF TYPICAL SECTION NO. 1 PRIOR TO PULVERIZATION OR COLD PLANE & ADJUST ALL UTILITY COVERS TO FINISHED GRADE AFTER PLACEMENT OF FINAL SURFACE COURSE, UNLESS SHOWN OTHERWISE ON THE PLANS.

*CORING DATA IS FOR INFORMATION ONLY. EXISTING SECTION MAY VARY FROM SECTION(S) FOUND AT CORING LOCATION(S). FABRIC MAY BE PRESENT IN SECTIONS EVEN IF NOT FOUND AT CORING LOCATION(S).

Corporate Office:
3485 Sacramento Drive, Suite A
San Luis Obispo, CA 93401
805.781.2265

YOUNT STREET TO NORTH TOWN LIMIT

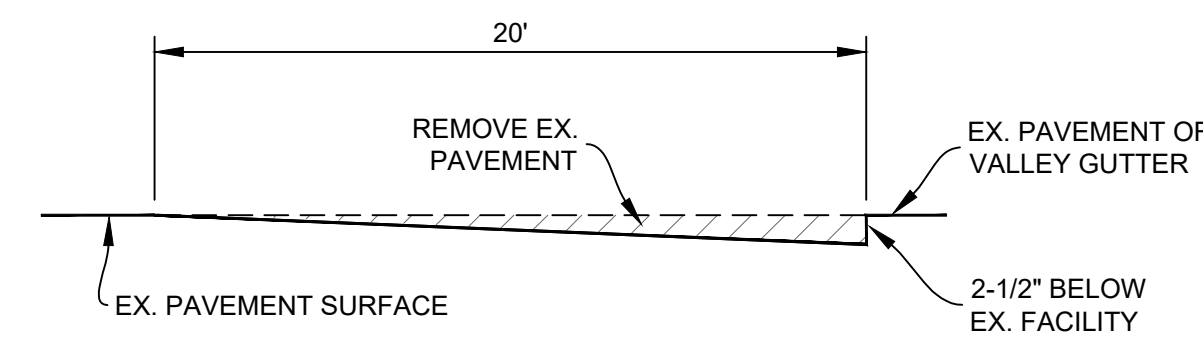
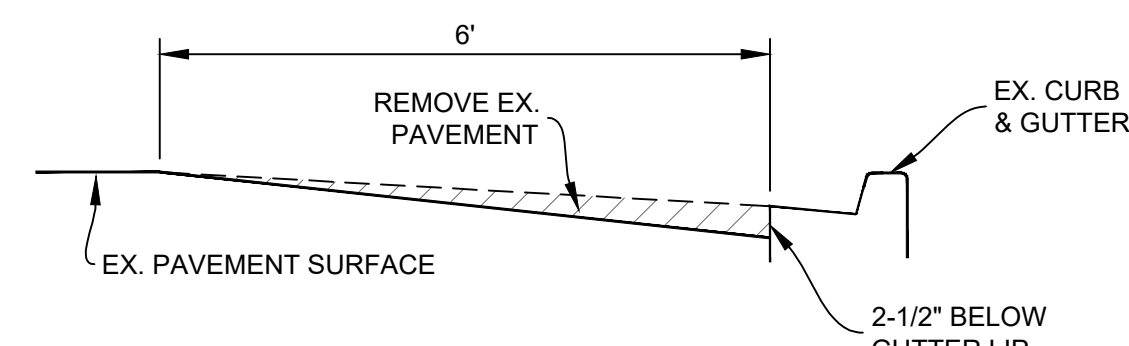
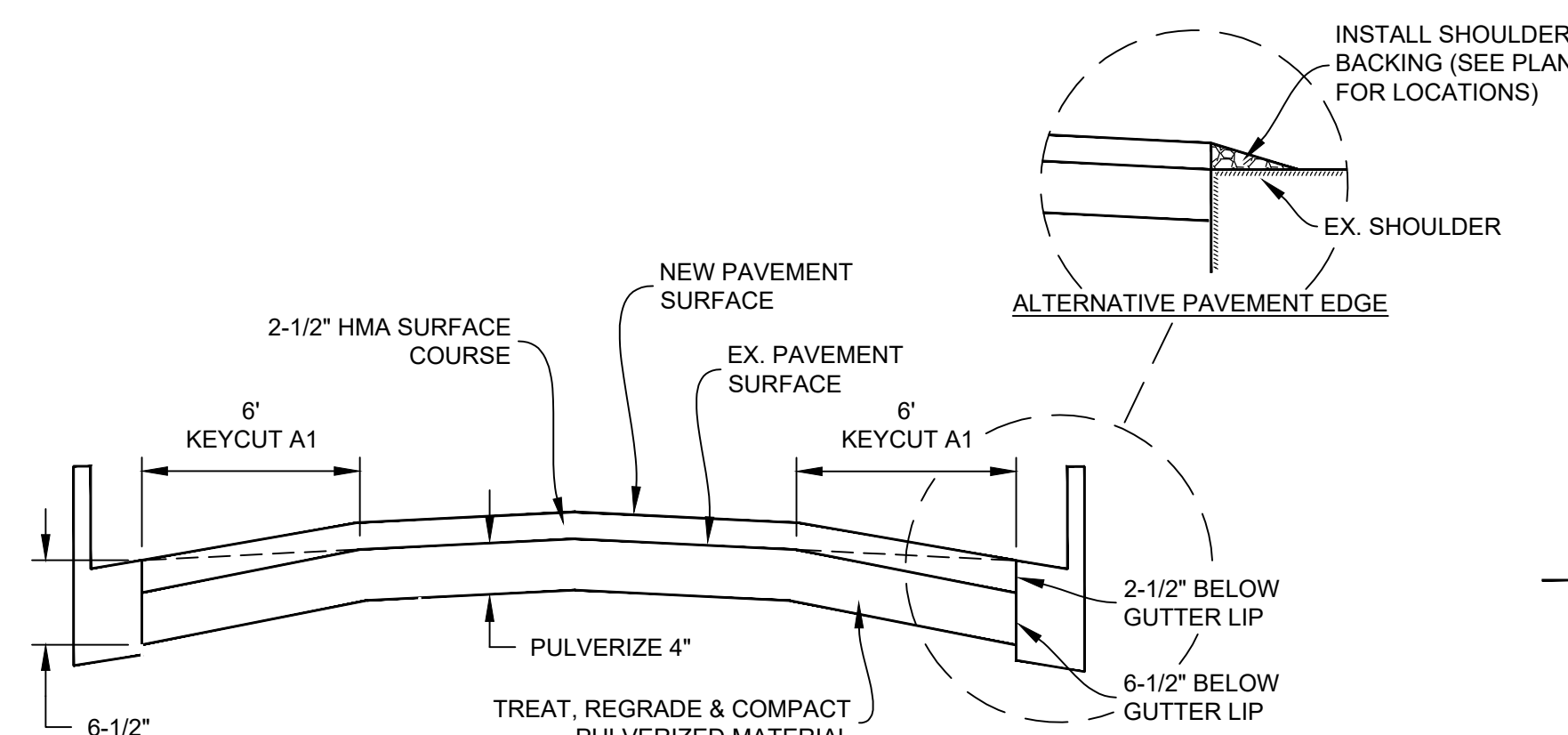
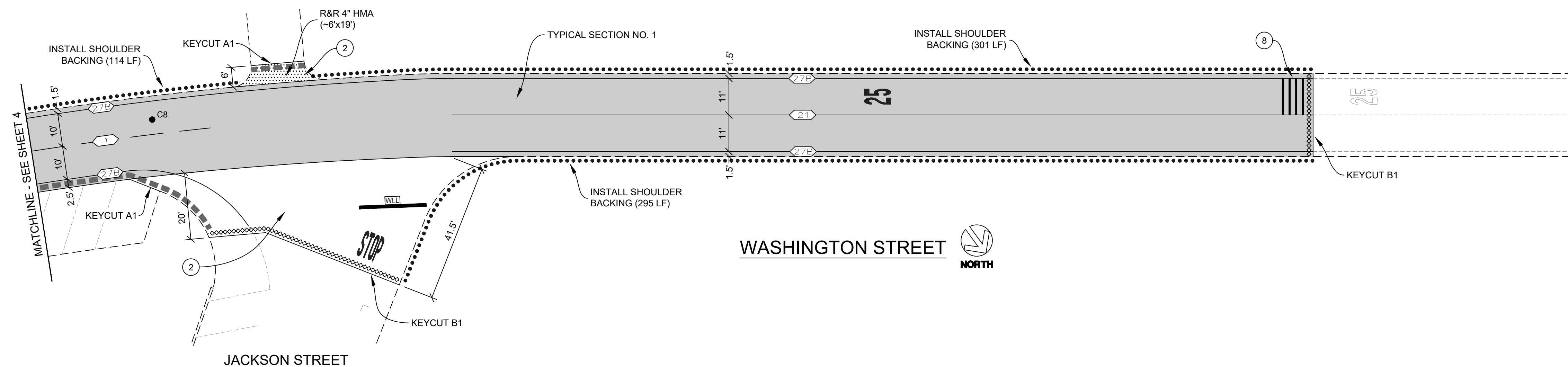

TYPICAL SECTION NO. 1

KEYCUT A1
(LONGITUDINAL KEYCUT)

KEYCUT B1
(TRANSVERSE KEYCUT)

CONSTRUCTION NOTES:

- ② NO PARTIAL DEPTH RECYCLE WORK. 2-1/2" HMA SURFACE COURSE ONLY.
- ⑧ REMOVE CERAMIC BUTTONS & INSTALL RUMBLE STRIPS.

MISCELLANEOUS NOTE:

1. LOWER ALL UTILITY COVERS WITHIN LIMITS OF TYPICAL SECTION NO. 1 PRIOR TO PULVERIZATION OR COLD PLANE & ADJUST ALL UTILITY COVERS TO FINISHED GRADE AFTER PLACEMENT OF FINAL SURFACE COURSE. UNLESS SHOWN OTHERWISE ON THE PLANS.

NOTES:

- NOTES:**
1. RECOMPACT EXPOSED SUBGRADE MATERIAL AT SURFACE. IF THE CONTRACTOR DISTURBS MORE THAN 1-1/2" OF MATERIAL, GRADE SHALL BE RECOMPACTED TO 95% R.C.
 2. CONTRACTOR SHALL NOTIFY TOWN 5 DAYS MIN. PRIOR TO DIGOUT OPERATION SO THAT REMOVAL LIMITS CAN BE FIELD MARKED.

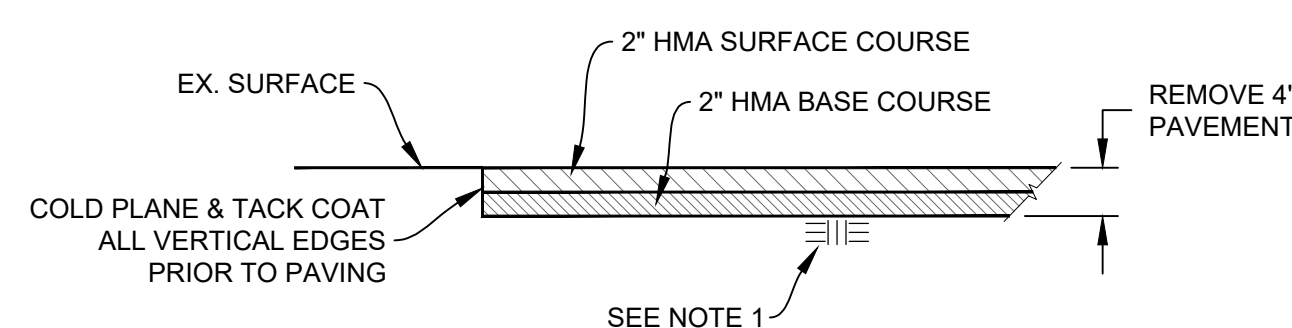

REMOVE & REPLACE 4" HMA

NOTE:

- NOTE:
1. NEW SHOULDER BACKING MATERIAL SHALL MATCH EX. SHOULDER MATERIAL. 3/4" CLASS 2 AGG. BASE SHALL BE PLACED WHEN EX. SHOULDER MATERIAL IS NATIVE SOIL.

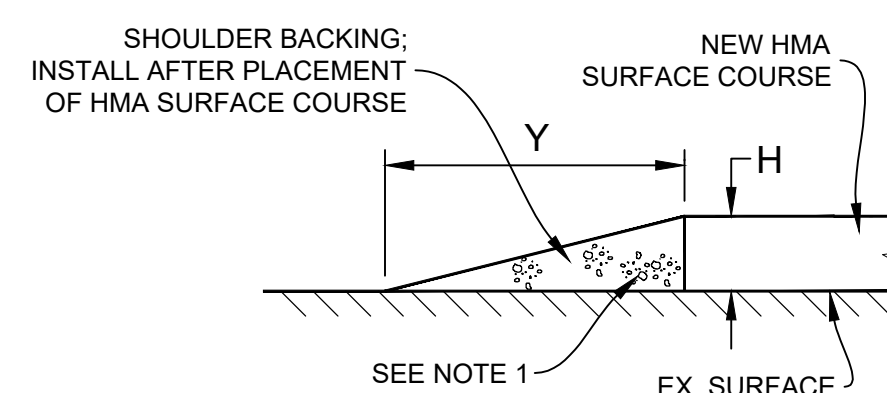

DIMENSION SCHEDULE	
H	Y
0"-1"	1'-0"
1"-2"	2'-0"
2"-3"	3'-0"
3"-4"	4'-0"

SHOULDER BACKING

BORING LOG

<u>NO.</u>	<u>AC</u>	<u>PCC</u>	<u>AB</u>	<u>R-VALUE</u>	<u>FABRIC (Y/N)</u>
C8	5"	5"	0"	-	Y

*CORING DATA IS FOR INFORMATION ONLY. EXISTING SECTION MAY VARY FROM SECTION(S) FOUND AT CORING LOCATION(S). FABRIC MAY BE PRESENT IN SECTIONS EVEN IF NOT FOUND AT CORING LOCATION(S).

P:\R\2\SHARED\DRIVE\ACTIVE PROJECTS\YOUNTVILLE TOWN OF\3\50087\DRAWINGS\50087-01_SITEL DWG. Plot Date: 4/29/2025 4:59 PM

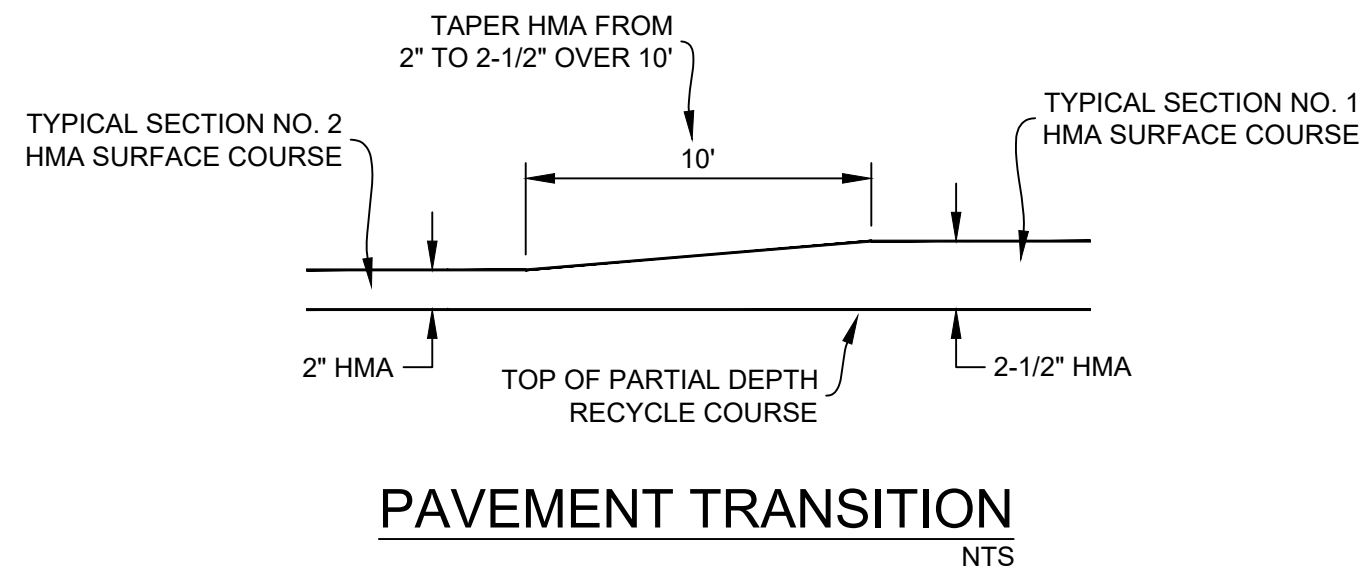
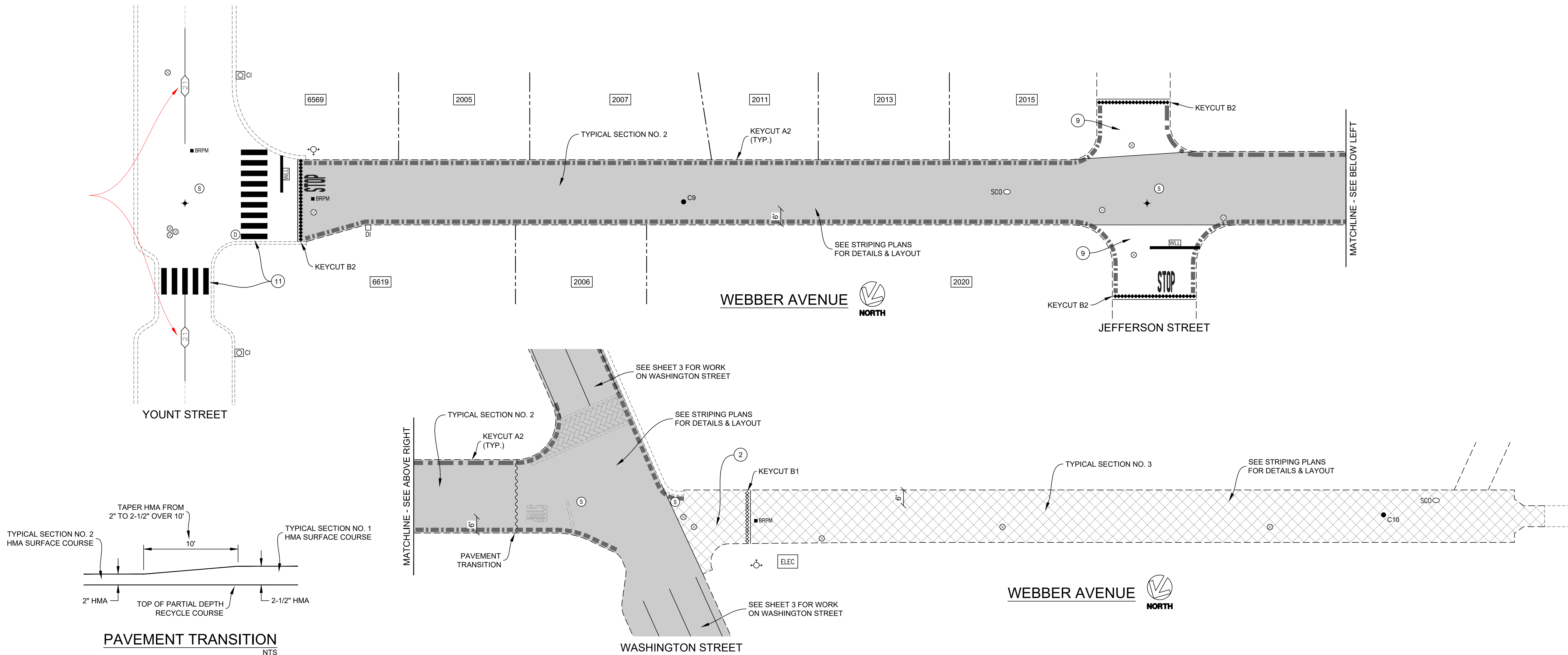

NOTE:
1. SEE PLAN FOR R&R HMA DEPTH & LOCATION. WHERE R&R HMA IS LOCATED UNDER KEYCUTS, PAVEMENT SHALL BE REMOVED TO THE SPECIFIED DEPTH AS MEASURED FROM THE PLANNED SURFACE, NOT THE EXISTING PAVEMENT SURFACE.

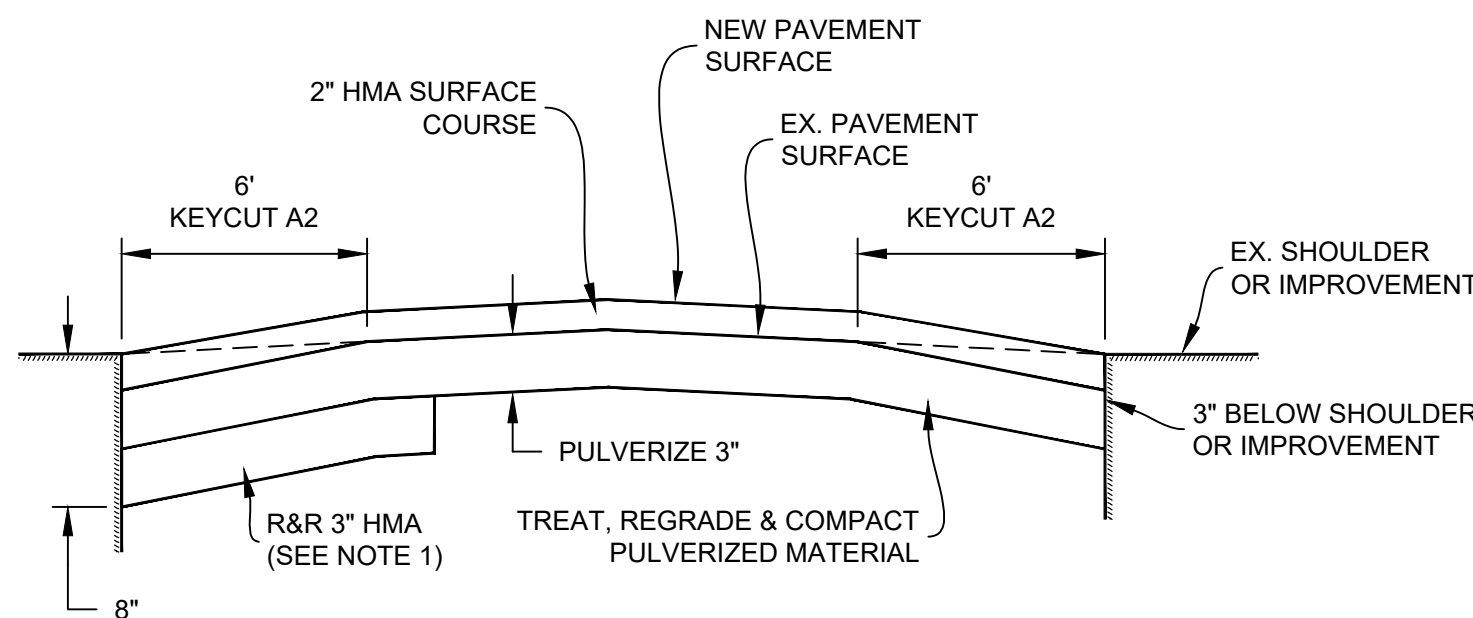

TYPICAL SECTION NO. 2
NTS

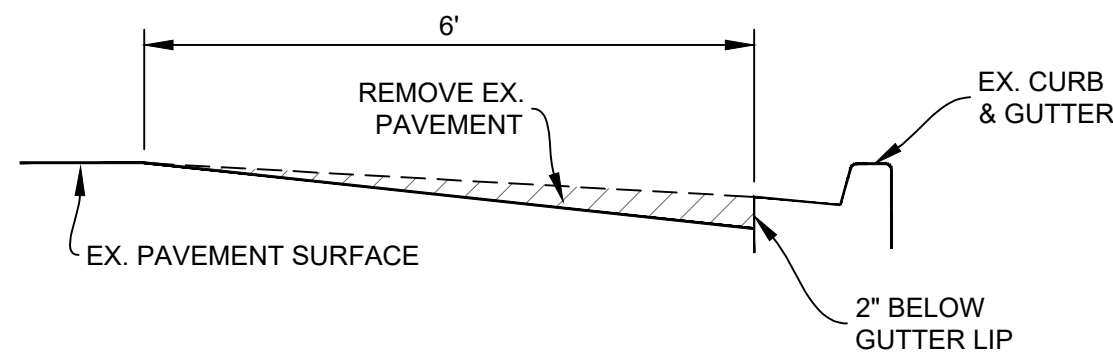

KEYCUT A2
(LONGITUDINAL KEYCUT)
NTS

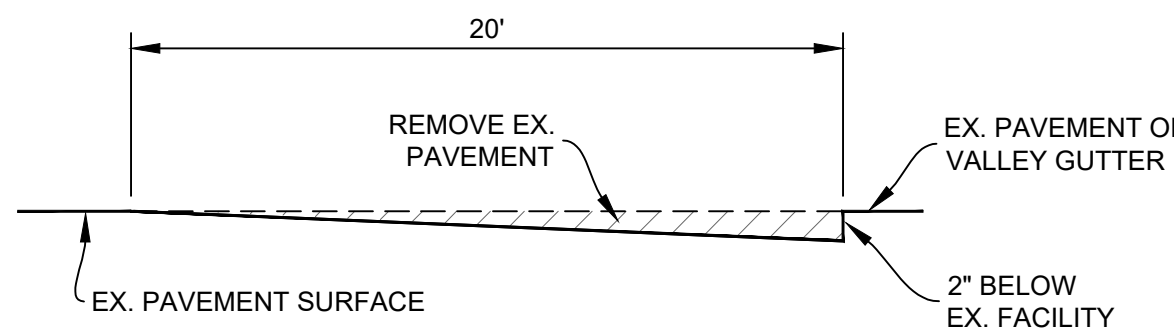

KEYCUT B2
(TRANSVERSE KEYCUT)
NTS

NOTE:
1. RECOMPACT LOOSENED MATERIAL AT SURFACE. IF CONTRACTOR DISTURBS MORE THAN 1-1/2" OF MATERIAL, SUBGRADE SHALL BE RECOMPACTED TO 95% R.C.

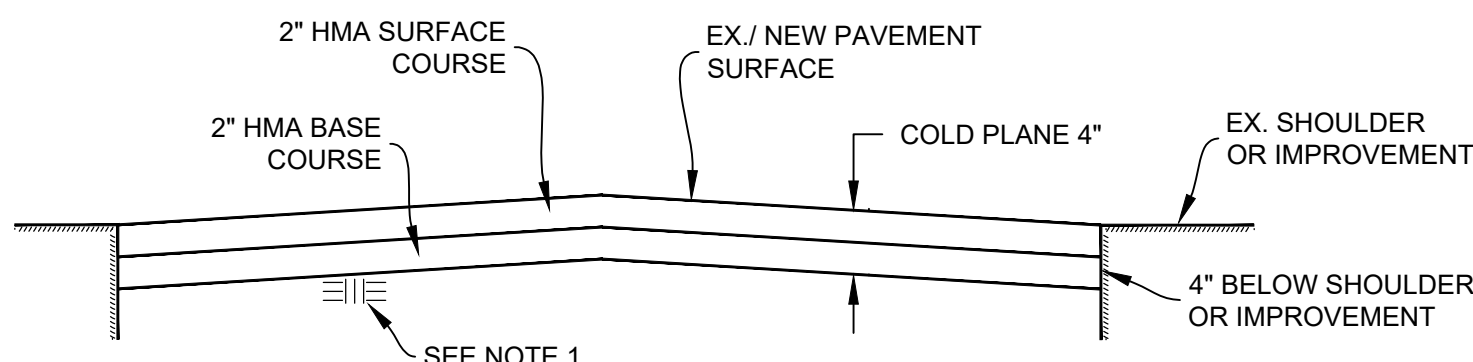

TYPICAL SECTION NO. 3
NTS

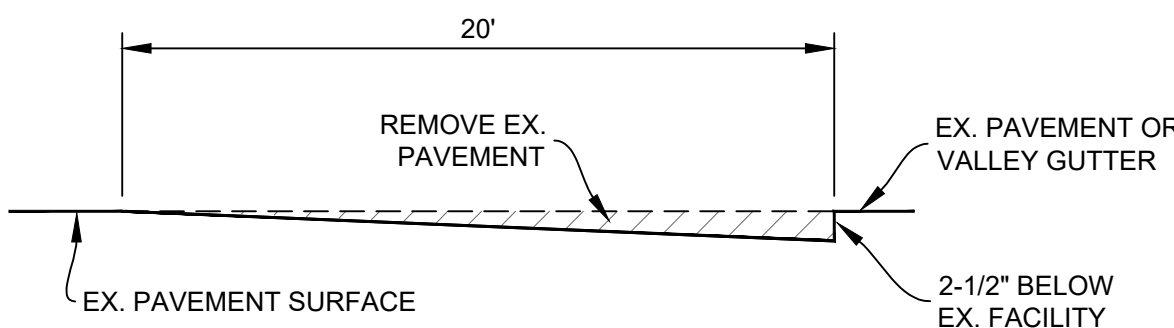

KEYCUT B1
(TRANSVERSE KEYCUT)
NTS

CONSTRUCTION NOTES:

- NO PARTIAL DEPTH RECYCLE WORK. 2-1/2" HMA SUFACE COURSE ONLY.
- NO PARTIAL DEPTH RECYCLE WORK. 2" HMA SUFACE COURSE ONLY.
- REMOVE EX. THERMOPLASTIC CROSSWALK, SEAL / PRIME PAVEMENT & INSTALL WHITE CONTINENTAL CROSSWALK (THERMO). BARS SHALL BE 2' WIDE, SPACED AT 4' O.C.

MISCELLANEOUS NOTE:

- LOWER ALL UTILITY COVERS WITHIN LIMITS OF TYPICAL SECTION NO. 2 & 3 PRIOR TO PULVERIZATION OR COLD PLANE & ADJUST ALL UTILITY COVERS TO FINISHED GRADE AFTER PLACEMENT OF FINAL SURFACE COURSE, UNLESS SHOWN OTHERWISE ON THE PLANS.
- FINAL HMA SURFACE COURSE ON WEBBER AVENUE SHALL BE PLACED PRIOR TO PAVING ON WASHINGTON STREET.

BORING LOG

NO.	AC	AB	R-VALUE	FABRIC (Y/N)
C9	4"	0"	15	N
C10	4"	0"	-	N

*CORING DATA IS FOR INFORMATION ONLY. EXISTING SECTION MAY VARY FROM SECTION(S) FOUND AT CORING LOCATION(S). FABRIC MAY BE PRESENT IN SECTIONS EVEN IF NOT FOUND AT CORING LOCATION(S).

Pavement Engineering Inc.

You can ride on our reputation



Corporate Office:
3485 Sacramento Drive, Suite A
San Luis Obispo, CA 93401
805.781.2265

TOWN OF YOUNTVILLE
MT-3026; MEASURE T WASHINGTON STREET REHABILITATION

WEBBER AVENUE
YOUNT STREET TO WEST END

DRAWN BY: EN

PROJECT NUMBER: 250087-01

SCALE: 1" = 20'

VERIFY SCALE

BAR REPRESENTS
1" ON ORIGINAL

DATE: APRIL 29, 2025

SHEET NUMBER: